



Sauter GmbH

Ziegelei 1
D-72336 Balingen
E-mail: info@kern-sohn.com

Tel. : +49-[0]7433- 9933-0
Fax: +49-[0]7433-9933-149
Internet: www.sauter.eu

Installation manual

SAUTER TVL-XL / TVL-XLS

V. 1.0
10/2022
EN

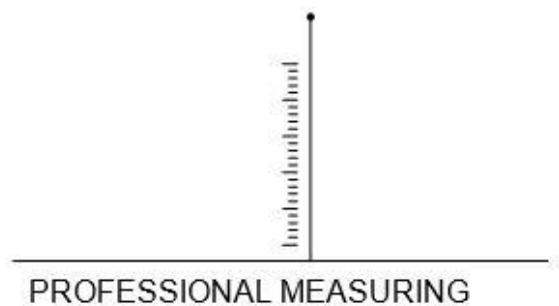

TVL-XL-BA-en-2210.docx



SAUTER TVL-XL / TVL-XLS

V. 1.0 10/2022

Installation manual

1 Introduction

These assembly instructions describe the assembly of the TVL-XLS set or the extension of your TVL test stand with the TVL-XL accessory.

2 Dismantling TVL



2.1 Dismantle length measuring device

Remove the cap screw that fixes the angle of the linear encoder to the base plate.

2.2 Dismantle base plate

Remove the four screws from the bottom of the base plate.

2.3 Brass bush

Remove the brass bush from the base plate.

3 Installation TVL-XL

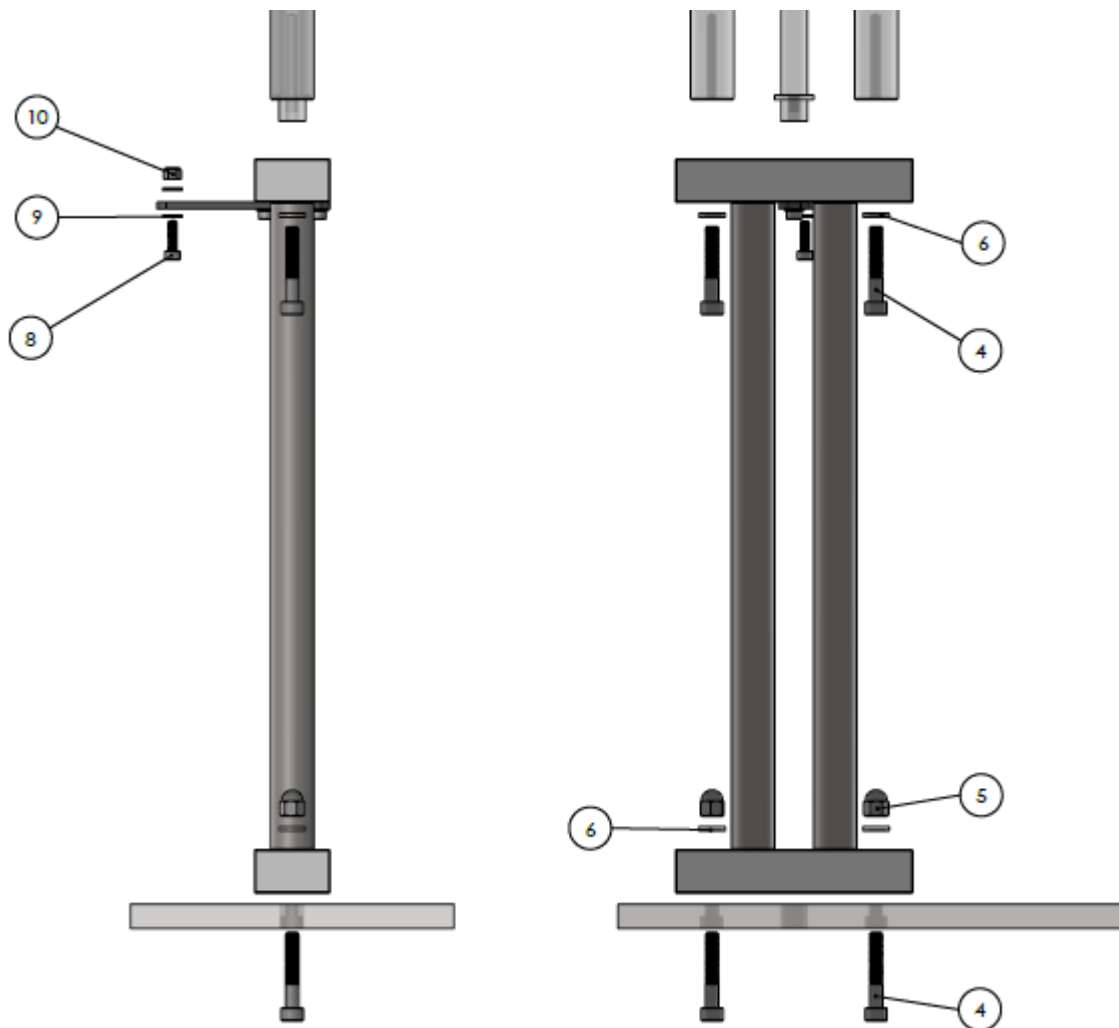

3.1 Extension set on base plate

Mount the extension set on the base plate using the screws (4), hexagon nuts (5) and washers (6) supplied. The mounting plate for linear encoders must be on the top of the right side of the test stand.

3.2 Brass bush

Insert the brass bushing into the top of the extension kit. Now screw the upper part of the TVL test stand to the extension set with the screws (4) and washers (6).

3.3 Length measuring device

Finally, fix the length measuring device to the plate of the extension set with the screw (8), washers (9) and hexagon nut (10).

4 TVL and TVL-XL assembled together

